

## Hængel / Hinge

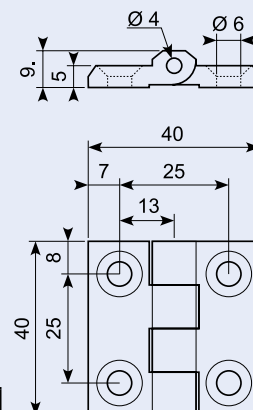
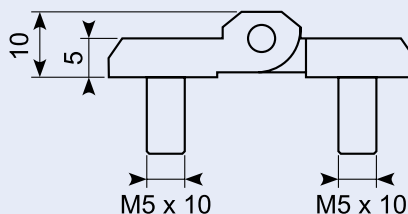

	PA, Black PA = Nylon PA6 GFR30	Zinkstøbt. Rå Zinc Die, RAW	Zinkstøbt. Sort Zinc Die, Black Coated	Zinkstøbt, forkromet Zinc Die, Chrome Plated
Med huller / With Holes	56.3009-100	56.3001-200 *		
Med huller / With Holes	56.3009-100S		56.3001-210S	56.3001-220S
Med skruer / With Screws		56.3001-201 *	56.3001-211S	
En side med skrue, en side med hul. / One side with hole, one side with screw		56.3001-205 *	56.3001-215 *	56.3001-225 *

Varenummer slutter med "S": Monteringstap er rustfri stål AISI 304.

Item Number ends with "S": Assembly Pin is Stainless Steel AISI 304.

### 56.3001-210S

Zinkstøbt hængsel. Sort med 4 huller og rustfri stift.

Zinc cast hinge. Black with 4 holes and stainless pin.

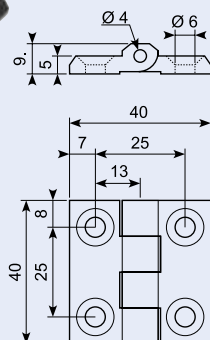

### 56.3001-500

Rustfri hængsel SS316. Rustfri SS304 stift.

Stainless hinge SS316. Stainless pin SS304.

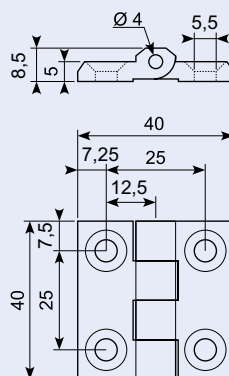

## Hængel / Hinge

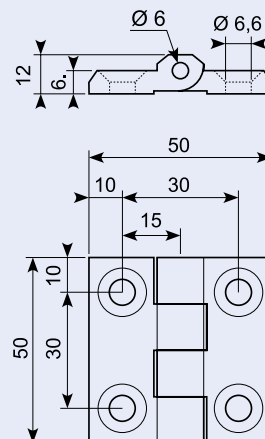
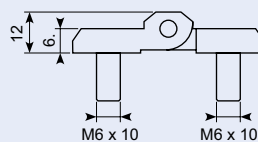

	PA, Black. PA = Nylon PA6 GFR30	Zinc Die, RAW	Zinc Die, Black Coated	Zinc Die, Chrome Plated
Med huller / With holes	56.3012-100	56.3011-200 *		
Med huller / With holes	56.3012-100S		56.3011-210S	56.3011-220S
Med skruer / With screws		56.3011-201 *	56.3011-211S	56.3011-221 *
En side med huller, en side med skruer / One side with hole, one side with screw		56.3011-205 *	56.3011-215 *	56.3011-225 *

Varenummer som slutter med "S": Monteringsstift er rustfrit stål AISI 304 (såsom 56.3011-200S)

Varenummer som slutter med "SS": Monteringsstift og skruer er rustfrit stål AISI 304 (såsom 56.3011-200SS)

Item Number ends with "S": Assembly Pin is Stainless Steel AISI 304 (such as 56.3011-200S)

Item Number ends with "SS": Assembly Pin and Screws are Stainless Steel

AISI 304 (such as 56.3011-200SS)

### 56.3011-500

Rustfri hængsel SS316. Rustfri stift  
SS304.

Stainless hinge SS316. Stainless pin SS304.

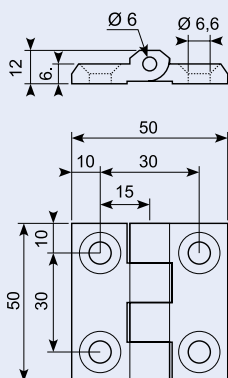

## Hængel / Hinge

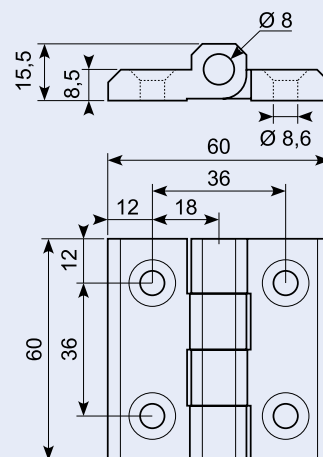
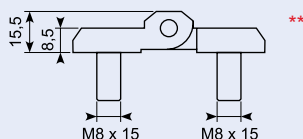

	PA, Black	Zinc Die, RAW	Zinc Die, Black Coated	Zinc Die, Chrome Plated
Med huller / With holes	56.3013-100	56.3013-200 *		
Med huller / With holes	56.3013-100S		56.3013-210S	56.3013-220S
Med skruer / With Screws		56.3013-201 *	56.3013-211S	56.3013-221
En side med huller, en side med skruer / One side with holes, one side with screws		56.3013-205 *	56.3013-215 *	56.3013-225 *

Varenummer slutter med "S": Monteringstap er rustfri stål AISI 304.

Item Number ends with "S": Assembly Pin is Stainless Steel AISI 304

## 56.3013-500

Rustfri hængsel SS316. Rustfri stift SS304.

Stainless hinge SS316. Stainless pin SS304.

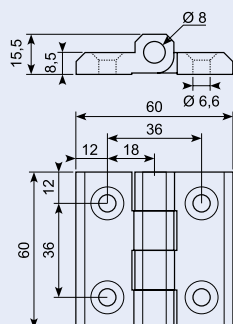

## 56.3070-210

Zinkstøbt hængsel. Sort med 4 huller.  
Zinc cast hinge. Black with 4 holes.

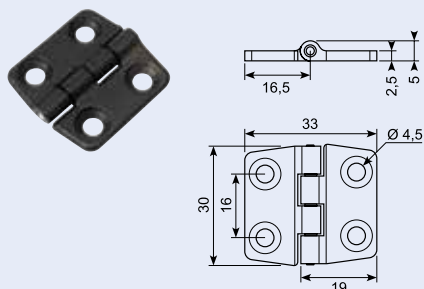

## 56.3081-210S

Zinkstøbt hængsel. Sort med 4 huller og rustfri stift.  
Zinc cast hinge. Black with 4 holes and stainless pin.

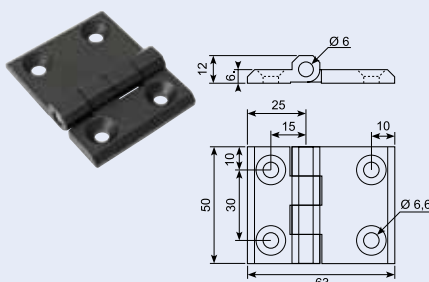

## 56.3181-210S

Zinkstøbt hængsel. Sort med 5 huller og rustfri stift.  
Zinc cast hinge. Black with 5 holes and stainless pin.

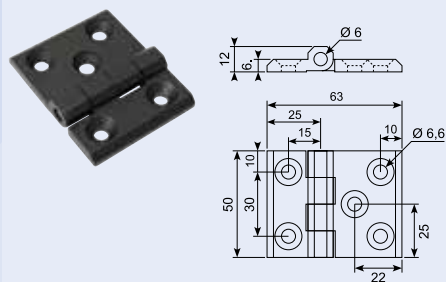

## 56.3080-210S

Zinkstøbt hængsel. Sort med 4 huller og rustfri stift.  
Zinc cast hinge. Black with 4 holes and stainless pin.

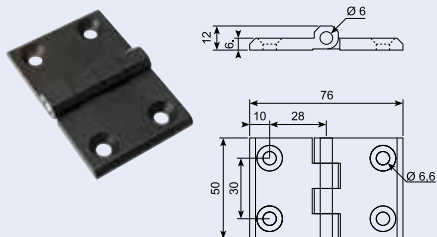

## 56.3180-210S

Zinkstøbt hængsel. Sort med 6 huller og rustfri stift.  
Zinc cast hinge. Black with 6 holes and stainless pin.

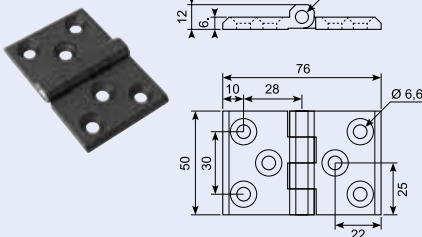

## 56.3015-210S

Zinkstøbt hængsel. Sort med 4 huller og rustfri stift.  
Zinc cast hinge. Black with 4 holes and stainless pin.

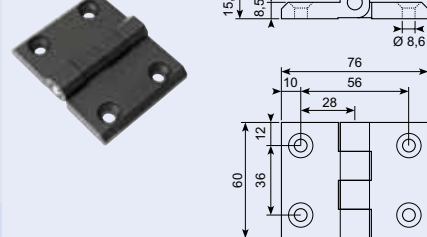

## 56.3016-210S

Zinkstøbt hængsel. Sort med 6 huller og rustfri stift.  
Zinc cast hinge. Black with 6 holes and stainless pin.

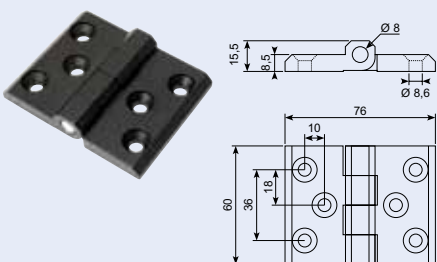

## 56.3081-500

Rustfri hængsel SS316. Rustfri stift SS304.

Stainless hinge. SS316. Stainless pin SS304.

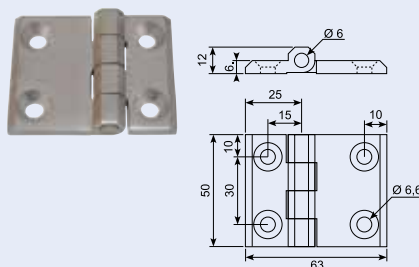

## 56.3080-500

Rustfri hængsel SS316. Rustfri stift SS304.

Stainless hinge SS316. Stainless pin SS304.

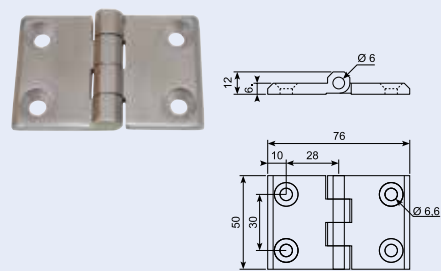

## 56.3084-500

Rustfri hængsel SS316.  
Stainless hinge SS316.

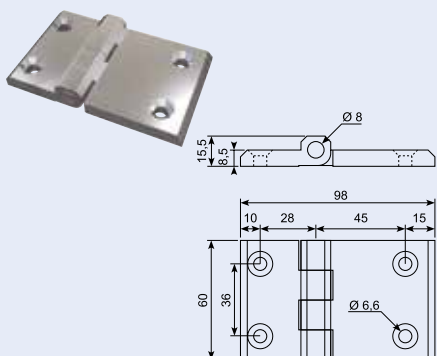

## Hængsel / Hinge

Sort zinkstøbt med rustfri stift. (Kan skaffes med jernstift).  
Black zinc alloy with stainless pin. (On demand with steel pin).

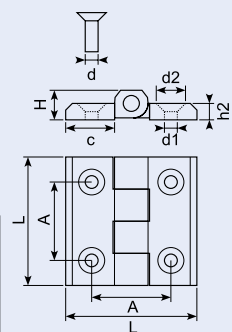

Vare nr. Part no.	L mm	A ± 0,25 mm	d mm	d1 mm	d2 mm	h2 mm	H mm	c mm
18.772222X	40	25	M5	Ø5,5	Ø10,5	5	9	14
18.772233X	50	30	M6	Ø6,5	Ø12,5	6	11,5	18
18.772244X	60	36	M8	Ø8,5	Ø16,5	8	15	21