

50.34128

Galvaniseret hængsel.
Zinc plated hinge.

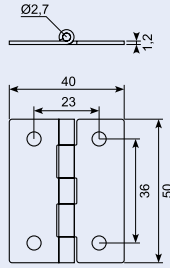

20.2830

Hængsel gulkrom.
53 x 50 x 1,5 mm
Udgår.

Hinge, yellow chrome. 53 x 50 x 1,5 mm. Discontinued.



20.13418A

Galvaniseret bladhængsel.
100 x 38 x 2 mm.

Zinc plated hinge. 100 x 38 x 2 mm.



63.05304

Bladhængsel. Krom. 2,5". 35 x 63,5 x 2 mm

Piano hinge, chrome. 2,5". 35 x 63,5 x 2 mm



50.9748

Galvaniseret hængsel med messingtap.
Løs stift.

Zinc-plated hinge with brass pin.

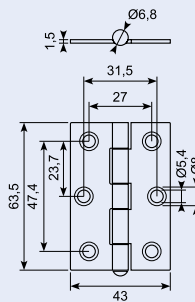

20.10256

Hængsel i forniklet stål. Udgår.

Hinge nickel-plated steel. Discontinued.

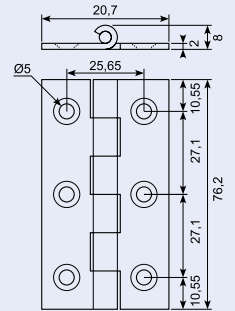

50.13709

Galvaniseret hængsel. Bukket med 2 mm åbning. 10 - 12 micron zink med messing stift.

Zinc plated hinge. Bent with 2 mm gap. 10 - 12 micron zinc with brass pin.

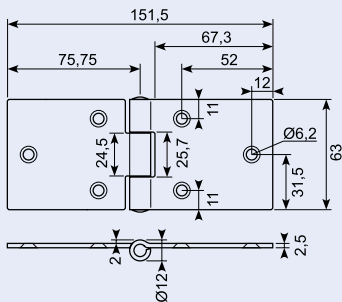

50.13709W

Stål, hvid pulverlakeret. Messingstift. Bukket med 2 mm åbning.
50.13709WSS - Rustfri stålstift.

Steel, white coated. Brass pin. Bent with 2 mm gap. **50.13709WSS** - Stainless steel pin.

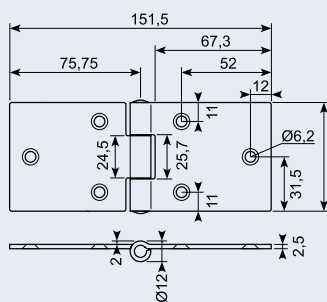

50.13709A *

Galvaniseret hængsel. Bukket med 2 mm åbning. Spec huller. 10 - 12 micron zink med messing stift.

Zinc plated hinge. Bent with 2 mm gap. Spec holes. 10 - 12 micron zinc with brass pin.

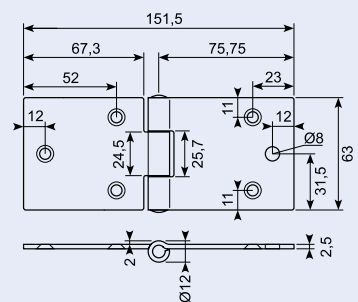

50.14160

Galvaniseret hængsel 10-12 micron. 60 x 74 x 3 mm.

Zinc plated hinge 10 - 12 micron. 60 x 74 x 3 mm.



50.34127

Hængsel sort pulverlakeret med ovale huller.

Hinge. Black coated with oval holes.

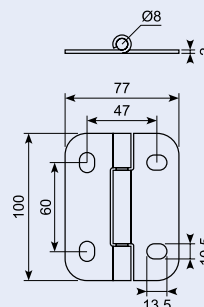

20.1360

Rudehængsel - fast. Sortlakeret alloy med rustfri stift og gummipakning for 5 mm glasrude.

Window/Hatch flat hinge. Black powder-coated with stainless steel pin and rubber gasket.

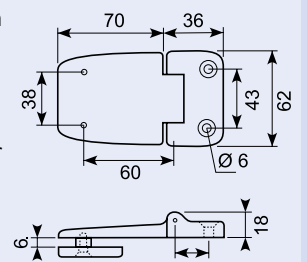

50.34119

Galvaniseret hængsel. LH venstre model.

Zinc plated hinge. LH left version.

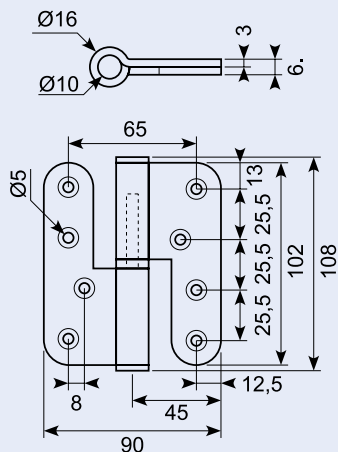

50.34120

Galvaniseret hængsel. RH Højre model.

Zinc plated hinge. RH right version.

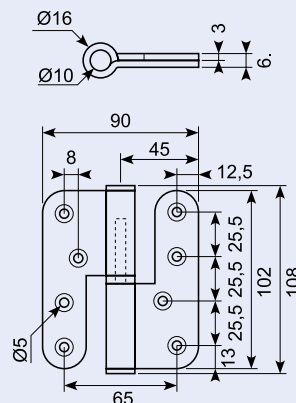

50.34117

Hængsel galvaniseret med smørenippel. Forkrøbet 3,6 mm.

Hinge. Zinc plated with grease nipple. Cranked 3,6 mm.

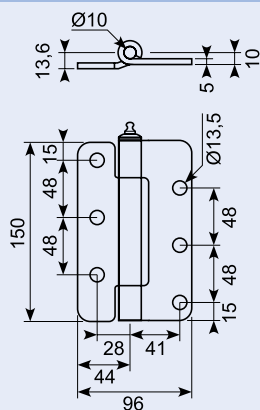

50.34116

Hængsel. Støbt. Sølvgrå. Heavy duty.

Hinge. Cast. Silver grey. Heavy duty.

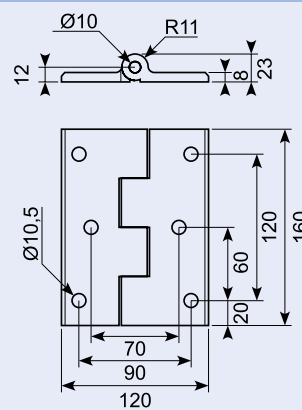

50.9576-3

Varmt galv. Hængsel m. messing tap, højre.

Hot dip hinge with brass pin, right model.

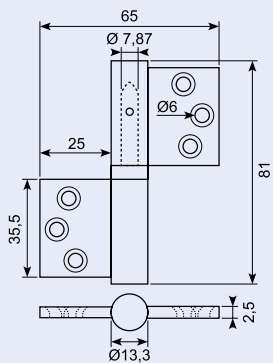

50.9576-4

Varmtgalvaniseret hængsel. Med messingtap, venstre.

Hot dip hinge with brass pin, LH.

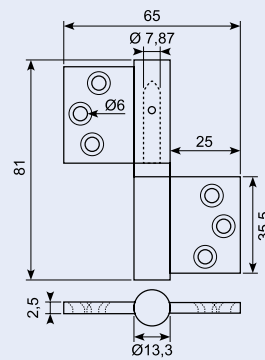
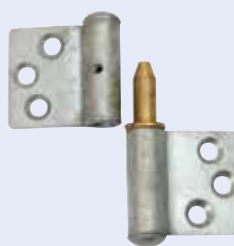

180 Lift off hinge

Housing: Zinc die, chrome plated or black coated

Pin: Steel, Zinc plated

	Black Coated	Chrome Plated
Varenr.	56.3067-210	56.3067-220 *

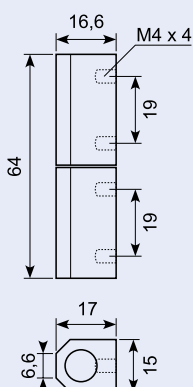
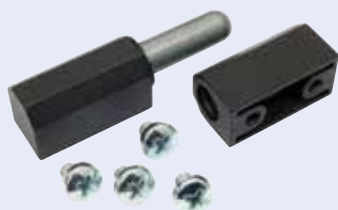

50.9752

Hængsel støbt. Galvaniseret med nylon bøsning.

Hinge. Cast. Zinc plated with nylon bushing.

